

"THE IDEA THAT ALL POOLS ARE CREATED EQUAL
JUST DOESN'T HOLD WATER."



NATARE AWS POOLS

All-welded unitized pool construction systems,
pre-engineered to the exact requirements of
each project.



Natare Pools

5905 West 74th Street | Indianapolis, IN 46278 | USA
(800) 336-8828 | (317) 290-8828
natare.com • natare@natare.com

WHY US?

NATARE FACT: Since 1969 we have completed over 7,500 projects around the world.

Natare Corporation is one of the world's more respected stainless steel pool manufacturers and suppliers of custom equipment for commercial swimming pools, water parks and aquatic centers, and high-end residential pools.

Our rugged, unitized wall system is joined to a self-supporting structural support system called a "buttress," which ensures pool stability whether empty or filled. The entire system is individually engineered and structurally designed using the most comprehensive computer design and modeling tools to provide a complete three dimensional model long before manufacturing or construction begins. We provide complete and detailed drawings for every pool we produce.



Natare pools provide years of trouble-free service with minimal upkeep and maintenance. Sparkling clear and clean water for a perfect competition environment.

WE GIVE YOU OPTIONS



A Natare pool gives you something you won't find anywhere else — options. Whether you're renovating an aging concrete pool and simply need a colorful lining system to make it watertight, or you need a brand new aquatic facility built from scratch, we will tailor a pool for you.

A full range of interior finish options are available to fit your project requirements and budget.

WHY AWAWS?

1 DURABLE AND LOW MAINTENANCE
The cracking, bulging and deterioration of typical concrete pool construction is eliminated because stainless steel resists the effects of hard use, weathering and settlement.

2 VIRTUALLY INDESTRUCTIBLE
Our pools are complete stainless steel structures, pre-engineered to the exact project requirements.

3 QUICKLY ASSEMBLED ON-SITE
Each of our stainless steel pools are individually engineered and structurally designed using the most comprehensive computer design and modeling tools.

4 FLEXIBLE DESIGN OPTIONS
Your pool project can have the luxurious curves and sinuous shape of a lazy river while still achieving the strength and stability that only all-welded stainless steel pool systems can provide.



ALL-WELDED | AWS POOL SYSTEMS

A Natare pool is furnished in corrosion-resistant, easily maintained stainless steel with a number 3 polished finish. Mirror finish, stainless and ceramic tile are also available for special applications.

Natare pools are the ideal choice for in-ground, on-ground or elevated aquatic construction and feature sectional design tailored to the exact configuration of each project. Pool components are pre-fabricated to the required sizes and assembled on-site using TIG welding techniques to form a one-piece, rugged, watertight system.



Club Cardio
Hamilton, NZ



Club Cardio
Hamilton, NZ



QEII (Eastern Rec)
Christchurch, New Zealand

BENEFITS:



Visit us online at:
www.natare.com

- certified to all current USA Swimming, FINA, NCAA, YMCA and NFHS standards
- ideal for recreational swimming, hydrotherapy and water aerobics
- suitable for in-ground, on-ground or elevated construction
- green — 100% recycled stainless steel
- heavy-gauge stainless steel construction
- unbreakable GPM grating

WHAT IS AN AWS POOL SYSTEM?

AWS pool systems are customized, all-welded unitized pool construction systems, pre-engineered to the exact requirements of each project.

Natare AWS is a permanent system that works with a variety of different floor systems including our Natatec® PVC pool lining system. Your pool project can have the luxurious curves and sinuous shape of a lazy river while still achieving the strength and stability that only all-welded stainless steel pool systems can provide. Interior finishes include polished stainless steel, ceramic tile and Natatec PVC pool lining. Other special finishes are available upon request.



CONTACT US TODAY TO SEE HOW WE CAN BUILD YOUR PROJECT ON BUDGET

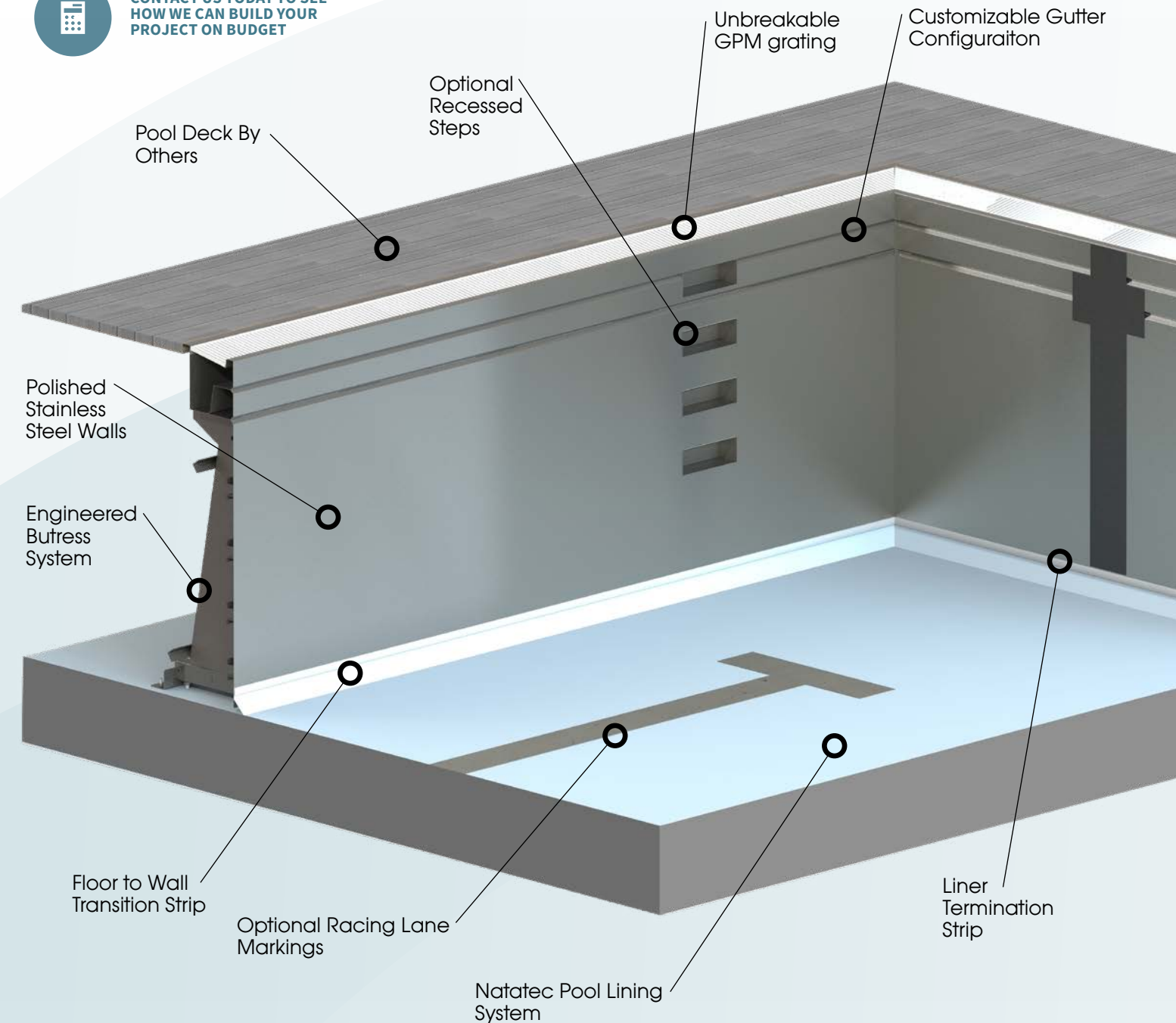

FEATURES AND BENEFITS:

- easily adapts to any size or shape pool including the curves and turns of lazy rivers.
- customizable gutter configuration.
- integral stainless water supply and distribution — no buried pipes.
- modular construction in sections up to 6 meters.
- epoxy coated, high-up durable butress system with integral deck support.
- low maintenance and easy to clean.



**WANT TO KNOW MORE ABOUT NATARE?
VISIT OUR WEBSITE WWW.NATARE.COM.**

“The idea that all pools are created equal just doesn’t hold water.”

HOW OUR AWS SYSTEM WORKS

Natare AWS Pool Systems quickly and easily construct to the most popular sizes of rectangular, rectilinear and radius pool shapes. Typical lap or competition pools include the standard 25 yard, 25 meter and 50 meter pools in configurations suitable for any level of competition or training. Radius sections or shapes are available, and Natare pools can be configured to provide an unlimited array of pools.

Each Natare pool is provided with complete and detailed drawings, and Natare pools are certified to be structurally sound and self-supporting, whether full or empty.

When used as a public pool or natatorium construction, Natare pool systems typically incorporate perimeter recirculating gutter systems or

perimeter overflow gutters, the most cost effective and functional way to construct any commercial pool. Excellent water distribution, fast water for competitive pools, wave-quelling gutter grating and no buried pool piping, combined with a Natatec pool lining system for the pool bottom, makes a Natare pool as close to maintenance-free as you can get.

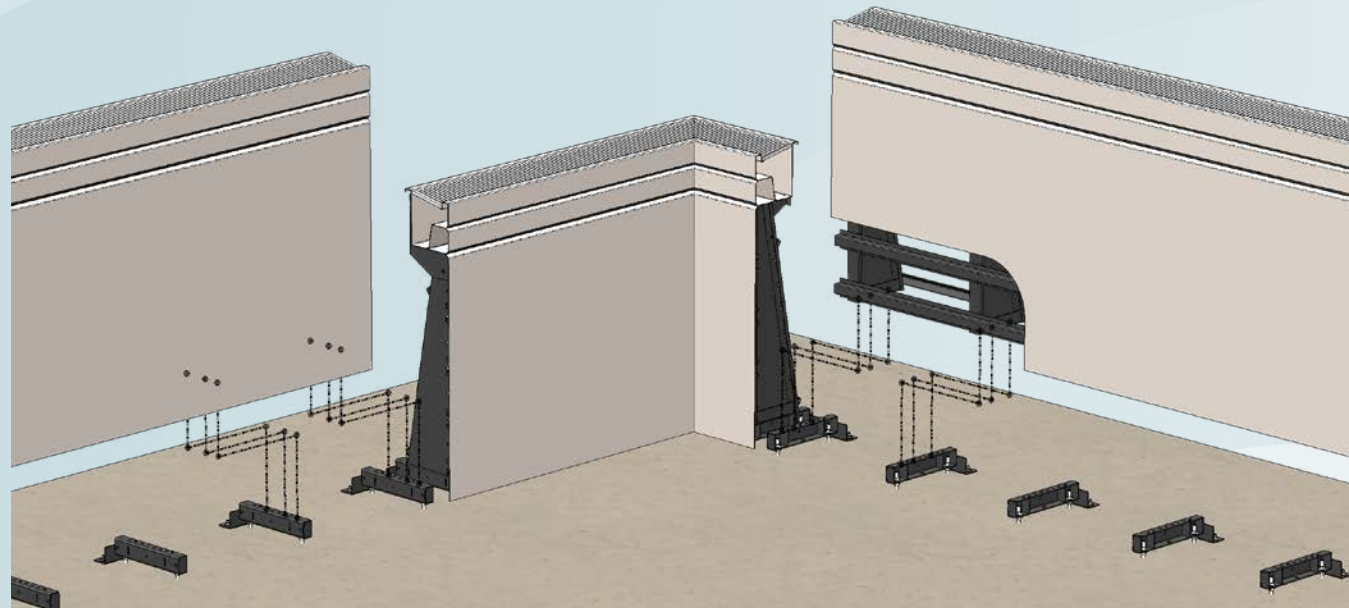

TYPICAL AWS POOL INSTALLATION

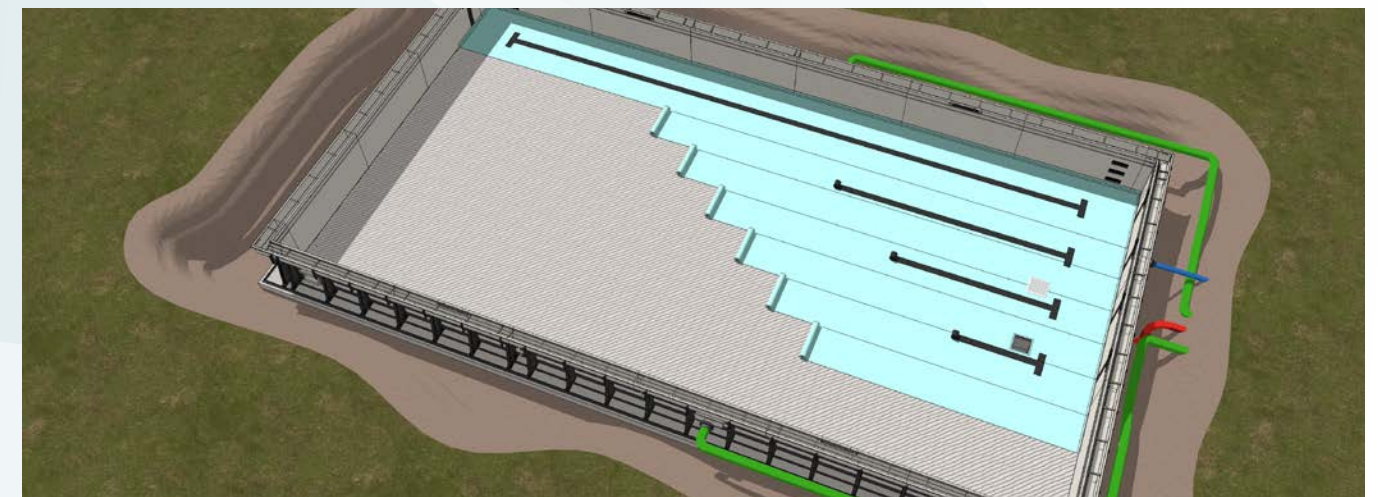
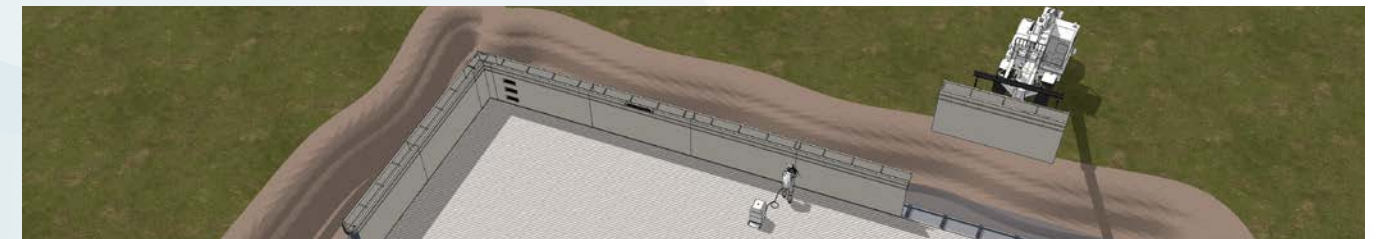
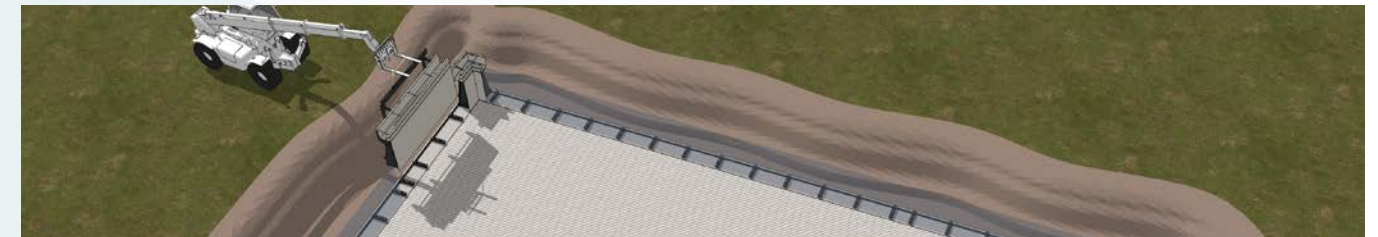
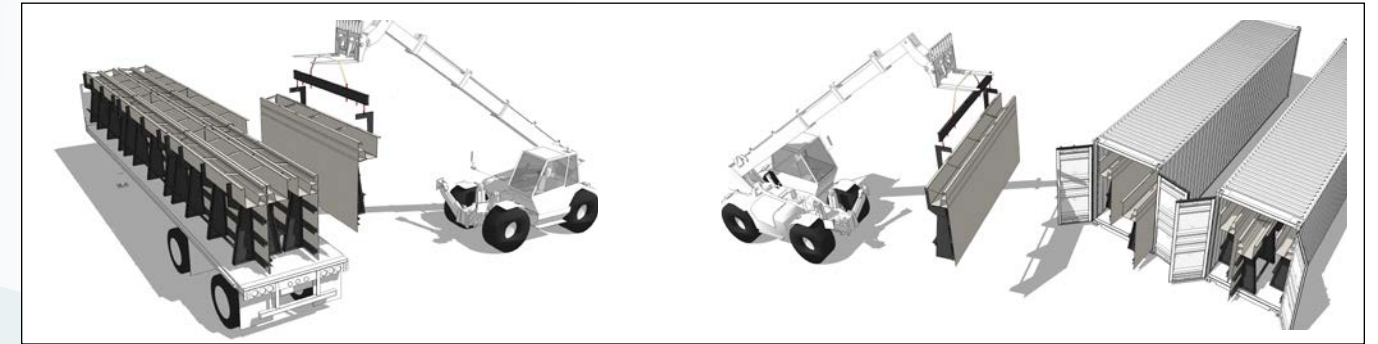

Questions? Contact us today at natare@natare.com

Visit us online at: www.natare.com

VISIT OUR WEBSITE FOR DOWNLOADABLE DOCUMENTS

FOR MORE INFORMATION USE THE QR CODES LOCATED ON EACH PRODUCT PAGE

CONTACT US TODAY TO SEE HOW WE CAN BUILD YOUR PROJECT ON BUDGET



Visit us online at:
www.natare.com

**NATARE
FACT:** Our stainless steel pools have
been know to last for over 40
years.

NATARE PRODUCTS AND SYSTEMS

A Natare pool can be designed to fit any space available. Looking to add a multi-purpose recreational pool for guests? A Natare AWS pool can easily be designed to create a unique atmosphere with a variety of depth changes, seating, stairs, spas within the pool and much more.



Perimeter Gutter Systems

Integral perimeter recirculating systems or overflow channel return systems provide the ultimate pool surround. Available in deck-level, semi-recessed, or fully recessed configurations in single channel, double channel, and positive suction return.



Natatec® Pool Lining Systems

Simply the most durable, cost-effective, and functional pool interior waterproofing system available. Build or renovate pools your way with the freedom to create attractive, functional, and watertight pool facilities.

Natare Fixed and Movable Bulkheads

The answer to multipurpose, functional pool systems, Natare pool bulkheads are world renowned for the perfect competition systems. Vertically deployed or laterally moved, Natare bulkheads are available for any pool configuration.



Grating Systems

Exclusive GPM polymer grating systems for pool surrounds, overflow systems or any pool, spa, or recreational environment. The first certified slip-resistant grating with a 10-year full replacement warranty.

MicroFlo® Filtration

High-capacity stainless steel vacuum sand and pressure filters in vertical or horizontal configurations. Available in sizes suitable for even the largest swimming pools, spas or water features; we sell the most economical, durable, and highest purity filtration available. An entire pool recirculation, filtration, and control system ready for fast, easy, and economical pool or water feature construction.



Natare equipment, systems and services are available from a worldwide network of distributors, representatives and experienced specialty contractors. Whether it is new construction, renovation or operation, talk to Natare.



Natare Pools

5905 West 74th Street | Indianapolis, IN 46278 | USA

(800) 336-8828 | (317) 290-8828

www.natare.com • natare@natare.com

Natare, the stylized N, MicroFlo and Natatec are trademarks of the Natare Corporation.

© Copyright 1997-2024 Natare Corporation. All rights reserved.